

# FreightLock User Guide

Automatic locking & seal mode, featuring  
challenge response



Call us on: +44 (0)161 429 1580 Visit us at: [maplefleetservices.co.uk](http://maplefleetservices.co.uk)

# FreightLock User Guide Automatic Locking & Sealing Mode

This vehicle is fitted with FreightLock IQ, a high security door lock and electronic, tamper evident seal.

## Accessing the Load Area

1.
- To release the door lock, press the white 'wake-up' button on the Maple control unit, located on the near-side of the vehicle, and present the white transponder fob to the display.



2.
- You can now open the rear doors. NB: If the door is not opened within 15 seconds the locks will re-engage.



## Securing the Load Area

3.
- Upon door closure the locks will automatically engage and a new 5 digit seal number will be generated.



4.
- To view the seal number, press the white 'wake-up' button on the Maple control unit once.

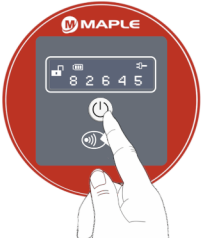

# FreightLock User Guide Unlocking via Challenge Response

The following user guide, details how to use unlock codes utilising the 'Challenge Response' access control procedure.

## Accessing the Load Area with PIN Codes

1.

Press the white 'action button' on the vehicle mounted control unit to reveal the seal number, then contact your fleet administrator, quoting the seal number to request an access code.

If you are a registered user visit [www.integritas-secure.net](http://www.integritas-secure.net) and login using your user credentials.

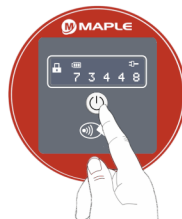

2.

To obtain an access code, once logged into the web portal, click 'Access Code' from the homepage. Select the vehicle from the 'Units' list, enter the current seal number displayed on the vehicle mounted control unit, add any notes, then click 'Get Code.' Your unlock code will then be displayed.



3.

To enter the unlock code into the vehicle mounted unit, press and hold the white 'action button,' until a cursor is displayed.

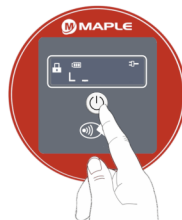

4.

Press the white 'action button' as many times as required to enter the first digit (i.e. press three times to enter number 3, or five times for number 5).

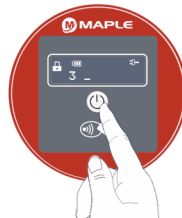

5.

Wait until the cursor moves to the next position and repeat stage 4 until all five digits have been entered. If a correct code is entered, the message 'Unlocked' will be displayed.

The lock will now retract and you can open the door. (NB: if you do not open the doors, the unit will re-lock after 15 seconds)

