

EC4 FreightLock User Guide

Manual Locking & Sealing Mode - Using a fob and
Challenge Response



Call us on: +44 (0)161 429 1580 Visit us at: maplefleetservices.co.uk

Manual Locking & Sealing Mode User Guide

The following user guide, details how to operate the security system in a manual locking & sealing mode with the use of a fob (Challenge Response compatible).

Securing the Load Area - With a Fob

1.

With the doors closed, press and hold the white 'action button,' until the locking prompt is displayed (the format is L#). Once the prompt is displayed, release the button and a cursor will appear (L _).

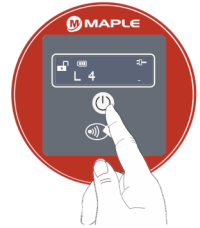

2.

With the cursor still displayed present a valid transponder to the antenna - The lock will engage and the message 'Sealed' will be displayed.

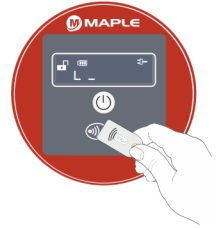

3.

To view the seal number, simply press the white 'action button.' at any time.

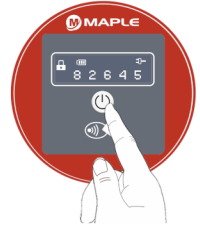

Accessing the Load Area - With a Fob

4.

Press the white 'action button' to wake-up the unit, revealing the current 5 digit seal number. With the seal number displayed, present a valid transponder to the antenna. The message 'unlocked' will be displayed and the locking bolt will retract, allowing the cargo doors to be opened.

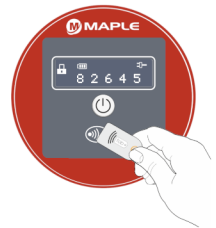

Manual Lock & Challenge Response User Guide

The following user guide, details how to use unlock codes utilising the 'Challenge Response' access control procedure in conjunction with a manual setting lock.

Securing the Load Area - With the Locking Code

1.

With the doors closed, press and hold the white 'action button,' until the locking number is displayed (the format is L#). Once the locking number is displayed, release the button and a cursor will appear.

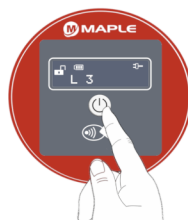

2.

With the cursor still displayed, press the 'action button' as many times as required to enter the single digit locking number (i.e. Press three times to enter the number 3).

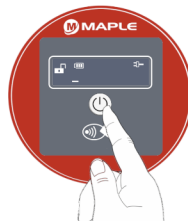

3.

With the correct number entered the unit will automatically lock and a new seal number will be generated.

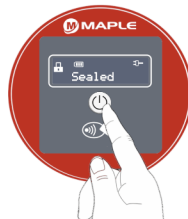

4.

To view the seal number, simply press the white 'action button,' at any time.

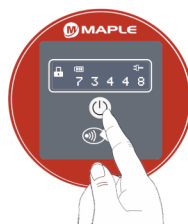

Manual Lock & Challenge Response User Guide

Accessing the Load Area

1.

Press the white 'action button' on the vehicle mounted control unit to reveal the seal number, then contact your fleet administrator, quoting the seal number to request an access code.

If you are a registered user visit www.integritas-secure.net and login using your user credentials.

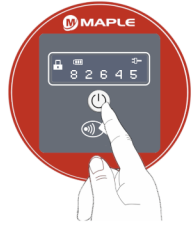

2.

To enter the unlock code into the vehicle mounted control unit, press and hold the white 'action button,' until a cursor is displayed.



3.

Press the white 'action button' as many times as required to enter the first digit (i.e. press three times to enter number 3, or five times for number 5).

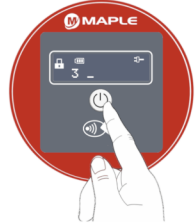

4.

Wait until the cursor moves to the next digit and repeat stage 4 until all five digits have been entered. If a correct code is entered a confirmation message will be displayed and the unit will unlock.

