



# BDI User Guide

Automatic locking & seal mode



Call us on: +44 (0)161 429 1580 Visit us at: [maplefleetservices.co.uk](http://maplefleetservices.co.uk)

# BDI User Guide Automatic Locking & Sealing Mode

This vehicle is fitted with Barndoor Integritas. The following user guide, details how to use the system with the automatic setting lock.

## To Lock & Seal the Cargo Doors

1.

Close the vehicle door and secure the door handle as normal. The unit will automatically lock and seal a few seconds after door closure.



2.

To view the seal number, press the white 'activation' button once.



## To Unlock & Unseal the Cargo Doors

3.

Press the white 'activation' button to wake-up the unit, then present a valid transponder to the antenna. The message 'unlocked' will be displayed.

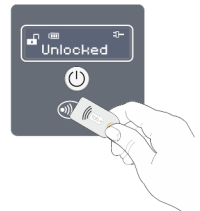

4.

Turn the handle to the unlock position and open the door as normal (NB: if you do not open the doors, the unit will re-lock after 30 seconds)

